

Vérin à chaîne pour :
fenêtres en saillie, fenêtres à
vasistas, fenêtres pour
mansardes.

Chain actuator for:
top hinged windows, bottom
hinged windows, roof
windows.

200N

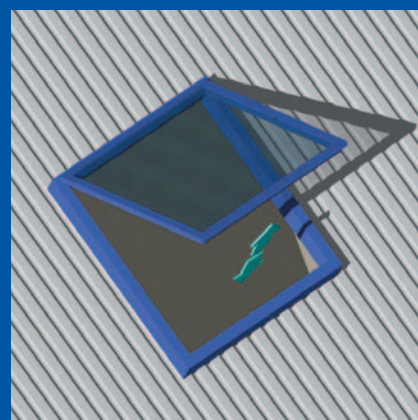
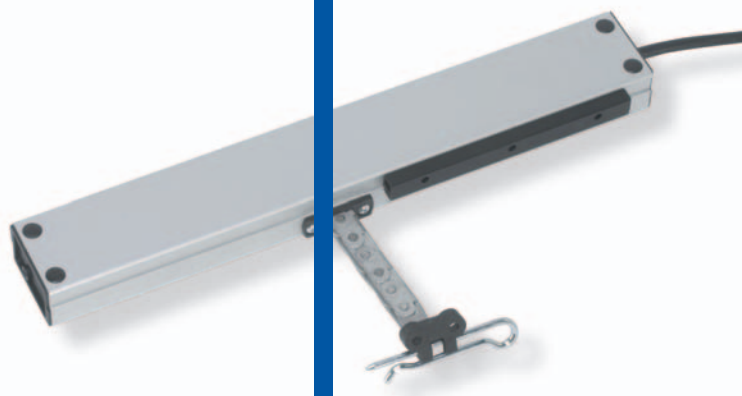
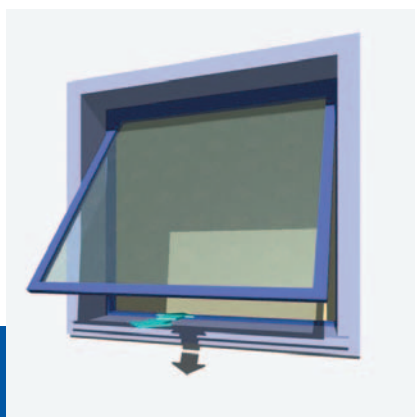

Dimensions très réduites
Very reduced dimensions

Chaîne à double maillon
Double-link chain

Basse consommation
Low consumption

Absence d'entretien
Maintenance free

Degré de protection: IP 20 / *Protection degree IP 20*

Fin de course fermeture-ouverture : Capteur Hall-Absorption / *Limit switch closing-opening: Hall sensor-Absorption*

Coloris: Anodisé argent (A) - Anodisé noir (N) - RAL 9016 (C)
Colour: Anodised silver (A) - Anodised black (N) - RAL 9016 (C)

DONNEES TECHNIQUES Micro S / TECHNICAL FEATURES Micro S

CODE CODE	DESCRIPTION DESCRIPTION	TENSION D'ALIMENTATION VOLTAGE	FORCE DE POUSSEE FORCE DE TRACTION THRUST TENSILE	COURSE STROKE	ABSORPTION MAXI CONSUMPTION MAX	VITESSE MINI SPEED MIN.
2700115	MICRO S 200 mm - A	230 V~ / 50 Hz	200 N	200 mm	30 W	ca. 10 mm/s
2700552	MICRO S 200 mm - N	230 V~ / 50 Hz	200 N	200 mm	30 W	ca. 10 mm/s
2700327	MICRO S 200 mm - C	230 V~ / 50 Hz	200 N	200 mm	30 W	ca. 10 mm/s
2700055	MICRO S 250 mm - A	230 V~ / 50 Hz	200 N	250 mm	30 W	ca. 10 mm/s
2700567	MICRO S 250 mm - N	230 V~ / 50 Hz	200 N	250 mm	30 W	ca. 10 mm/s
2700328	MICRO S 250 mm - C	230 V~ / 50 Hz	200 N	250 mm	30 W	ca. 10 mm/s
2700116	MICRO S 200 mm - A	24 V =	200 N	200 mm	20 W	ca. 10 mm/s
2700562	MICRO S 200 mm - N	24 V =	200 N	200 mm	20 W	ca. 10 mm/s
2700329	MICRO S 200 mm - C	24 V =	200 N	200 mm	20 W	ca. 10 mm/s
2700117	MICRO S 250 mm - A	24 V =	200 N	250 mm	20 W	ca. 10 mm/s
2700578	MICRO S 250 mm - N	24 V =	200 N	250 mm	20 W	ca. 10 mm/s
2700330	MICRO S 250 mm - C	24 V =	200 N	250 mm	20 W	ca. 10 mm/s

LES VALEURS DE PERFORMANCE REPORTEES SUR LE TABLEAU SONT VERIFIEES A UNE TEMPERATURE DE FONCTIONNEMENT DE -10°C/+40°C AVEC UNE HUMIDITE RELATIVE MAXIMALE DE 60%.
THE VALUES INDICATED ON THE TABLE WERE RECORDED IN A CLIMATIC TEST CHAMBER AT OPERATING TEMPERATURES BETWEEN -10°C/+40°C WITH MAX 60% RELATIVE HUMIDITY.

DESCRIPTION DE CAHIER DES CHARGES:

Vérin électrique linéaire MINGARDI avec mouvement à chaîne articulée contenue à l'intérieur de l'enveloppe. Fonctionnement avec tension d'alimentation 230V~50Hz ou 24V CC. Conforme aux Directives 73/23 LVD – 89/336 EMC comme modifiées par les disciplines 93/68 CE (pour le fonctionnement à 24V CC conforme aux Directives 89/336 EMC comme modifiées par les disciplines 93/68 CE). Prévu d'un système de fin de course électronique. Connectable en parallèle. Coloris disponibles: anodisé argent/anodisé noir RAL 9016.

DESCRIPTION OF SPECIFICATIONS

MINGARDI linear electric actuator with reinforced double-sprocket chain inside the actuator body. Operation at 230V~ 50 Hz. o 24V DC voltage. In conformity with Directives 73/23 LVD - 89/336 EMC as modified by 93/68 CE (compliant with Directives 89/336 EMC as modified by 93/68 CE for 24V DC operation). Outfitted with electronic limit switch system for opening and closing, which can be connected in parallel. Colours available: anodised silver or anodised black / 9016 RAL.

Micro S Dessin dimensionnel / Micro S Scale drawing

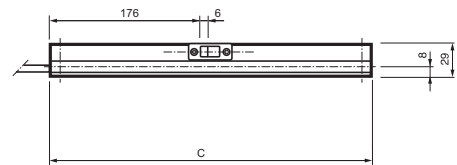
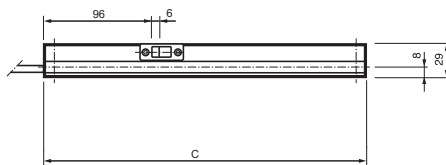
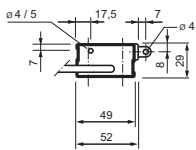
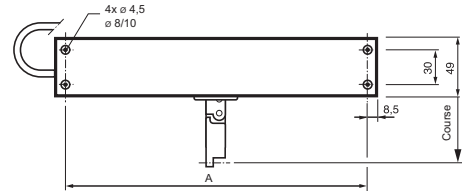
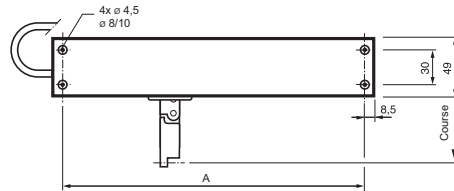

VERSION 24V CC
24V DC VERSION

Course/Stroke	A	C
200	224	261,4
250	269	286,4

VERSION 230V AC
230V AC VERSION

Course/Stroke	A	C
200	324	341
250	349	366

Accessoires - Pièces de Rechange / Accessories - Spare parts

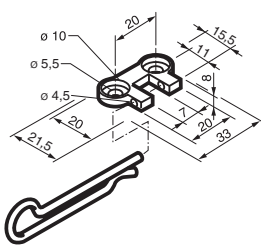

2700093

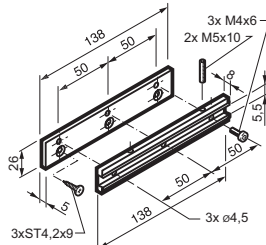

2700094

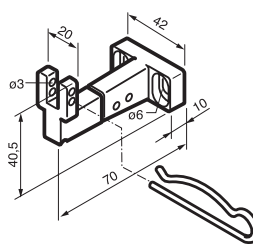

2700096

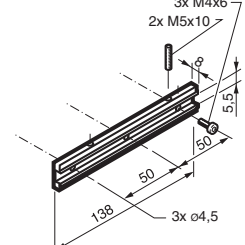

2700080

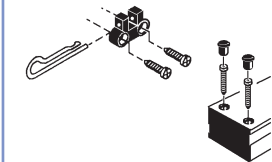

2700096

ACCESSOIRES DE FIXATION / FIXING ACCESSORIES

CODE CODE	DESCRIPTION DESCRIPTION
2700093	Kit universel pour applications sur fenêtres en saillie Universal kit for fitting top-hinged windows
2700094	Kit universel pour applications sur fenêtres à vasistas Universal kit for fitting bottom-hinged windows
2700096	Kit universel pour applications sur fenêtres à mansarde Universal kit for fitting roof windows
2700080	Groupe bride basculante Pivoting bracket for horizontal plane applications

PIECES DE RECHANGE / SPARE PARTS

CODE CODE	DESCRIPTION DESCRIPTION

ACCESSOIRES DE COMMANDE : Pour plus d'informations prière de contacter notre service technico-commercial
CONTROL ACCESSORIES: please contact our technical support service for further information